

CHAMBER OF COMMERCE

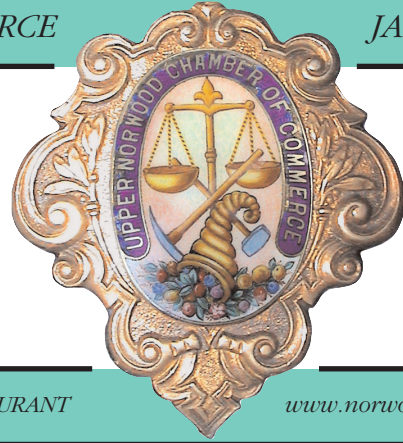

NEXT MEETING: 7PM ON TUESDAY 3RD FEBRUARY 2004 AT LORENZO'S RESTAURANT

www.norwoodchamber.org.uk

For more information about the chamber, its objectives, minutes of the last meeting, copies of our newsletter and the opportunity to join the mailing list visit www.norwoodchamber.org.uk

CRYSTAL CLEAR DEVELOPMENT

Plans for a 150m long glass palace in the sky, the first new building on the site of the old Crystal Palace since it burnt down in 1936, have been revealed by award-winning architect Wilkinson Eyre. The scheme, set in what would be the only dedicated sculpture park in the capital, aims to restore Crystal Palace to its position as an internationally renowned, cultural focal point for London.

Wilkinson Eyre was approached by the Crystal Palace Campaign committee, the organisation created in opposition to proposals for a multiplex scheme on the site, to submit proposals for a Sculpture Park. Its design realises the brief by combining a sculpture park with an iconic building made of glass. Elevated 54m above Crystal Palace Park in South London and providing London's skyline with a new landmark, the £45 million glass structure marks a sensitive response to a site coloured by its architectural

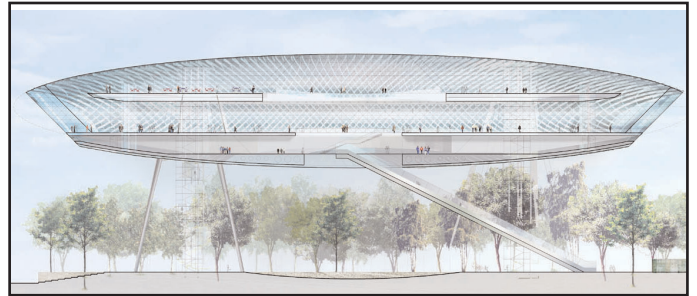

past. Funding for the project will be sought through fundraising, corporate sponsorship and grants.

Given the recent history of campaigns concerned with the top site it is unsurprising to see it has attracted criticism, not least because of the apparent defection of Philip Kolvin to the 'dark side' of development. But this is a shame because if anything is to be done about improving the park (which we think we'd all like to see) we should not be hostile to those who take the time and trouble to make a proposal even if it is one that isn't in the mind's eye.

Indeed, whilst the local media have been having a field day in rolling out article after article to condemn the proposals it might be that this is the sort of project our local community actually wants ... an online poll conducted by Virtual Norwood Forum suggests some underlying support.

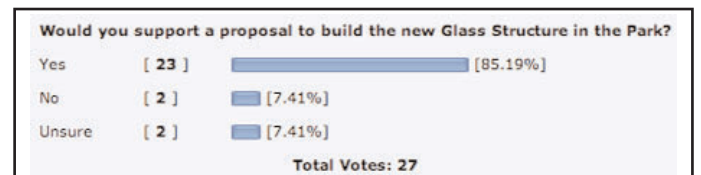
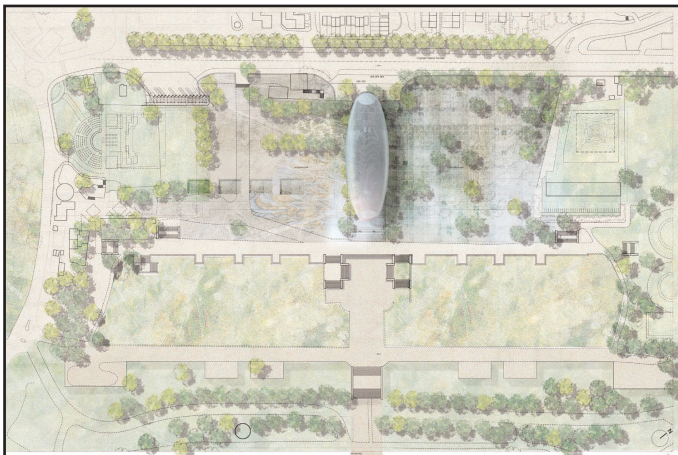

CHAMBER OF COMMERCE

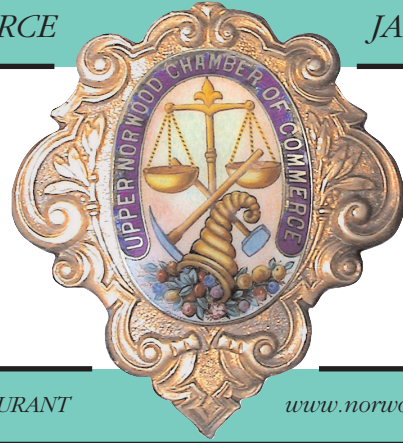

NEXT MEETING: 7PM ON TUESDAY 3RD FEBRUARY 2004 AT LORENZO'S RESTAURANT

www.norwoodchamber.org.uk

For more information about the chamber, its objectives, minutes of the last meeting, copies of our newsletter and the opportunity to join the mailing list visit www.norwoodchamber.org.uk



PENNY FOR THE GUY

A ceremony for switching on the Christmas lights held on Friday 28th November was a great success. Players from Crystal Palace FC and Croydon Deputy Mayor turned the lights on and entertainment was provided by Fusion Radio, Don Steel Jazz Band and Bright Sparks Theatre Group. The event was coordinated by Town Centre Manager Sharon Baldwin and was perfect except for one small detail ... when the local media arrived for the photo call they couldn't find Santa. He'd gone to spend a penny!

PROMOTIONAL PENS

To raise awareness of the Chamber of Commerce we are distributing personalised pens free of charge to Chamber members and shops and offices on the Triangle.



FREEPOST ADDRESS

Our new address for correspondence is:
Crystal Palace & Norwood Chamber of Commerce
FREEPOST NAT11932
London SE19 1BR

WESTOW HILL/STREET JUNCTION

James Slattery-Kavanagh, Chairman, spoke at the Norwood Area Committee public meeting held on Thursday 4th December at Rosendale Primary School about the urgent need for improvements to the Westow Hill/Street Junction. The panel explained that they had lobbied the council but made little progress.

GETTING RESULTS

It has only been a few months since The Chamber of Commerce was relaunched and already we are getting results. In our newsletter for October 2003 we highlighted the dead shrubs in upturned sewer pipes that were loitering on our pavements. Local traders were extremely pleased to see them go.

